

Date: 4.18.2024

Addendum No. 2

*Farmers Alliance Mutual Insurance
1122 North Main Street
McPherson, Kansas 67460*

Architect's Project Number: 22.31

Addendum No. 2 (Articles 2.1 thru 2.3) 1 Pages + Attachments

Issued By:

Plan4 Architecture Design

303 North Main Street
McPherson, Kansas 67460

You are instructed to read and to note the following described changes, corrections, clarifications, omissions, deletions, additions, approvals, and statements pertinent to the Contract Bid and Construction Documents.

Addendum No. 2 is a part of the Contract Bid and Construction Documents and shall govern the performance of the Work. Attached Information

Article 2.1. Specifications: 001116 – Invitation to Bid – Section 1.2.A.1 (See Attached)

A. **Replace** Bid Date: from April 18, 2024, to April 25, 2024. Bid Time to remain the same.

Article 2.2. Architectural: A010 Finish Schedule (See Attached)

A. **Add** floor tile control joints and expansion joints.

Article 2.3. Electrical: E301 Electrical Floor Plan - Lighting

A. **Remove** Note at the top of the sheet "CUSTOM LED STRIP @ CLOUDS BY JLC TEC, LED CEILENCIO. REFERENCE SPEC. (TYPICAL)".

End of Addendum #2

FINISH MATERIAL LIST

FLOORING	BASE	PAINT
F-1 FLOOR TILE MFR: ANATOLIA / VIRGINIA TILE STYLE: INDUSTRIA HD PORCELAIN TILE COLOR: LITHIUM, RECTIFIED SIZE: 24"x48"x13/32" MORTAR: SCHLUTER ALL-SET, GRAY CRACK ISOLATION BARRIER: SCHLUTER DITRA GROUT: TEC POWER GROUT - SLATE GRAY PATTERN: 33% OFFSET	B-1 TILE BASE @ NON-TILED WALLS MFR: ANATOLIA / VIRGINIA TILE STYLE: INDUSTRIA HD PORCELAIN TILE COLOR: LITHIUM, RECTIFIED SIZE: 12"x24"x13/32" CUT - 4" FINISHED HEIGHT MORTAR: SCHLUTER ALL-SET, GRAY GROUT: TEC POWER GROUT - SLATE GRAY TOP TRIM: SCHLUTER QUADEC 7/16", LIGHT ANTHRACITE	PRIMER SHERWIN WILLIAMS: PROMAR 200 PRIMER (B28W2600) (INTERIOR WALLS & CEILING) PT (1 PRIME COAT, 2 FINISH COATS) PT-1 WALL PAINT MFR: SHERWIN WILLIAMS - SUPER PAINT COLOR: UNCERTAIN GRAY SW 6234 FINISH: SATIN
F-2 CARPET TILE MFR: J&J INVISION STYLE: COLOR: SIZE: PATTERN: QUARTER TURN NOTE: FIELD VERIFY, REPLACE AS REQUIRED	B-2 BASE @ CASEWORK MFR: WILSONART COLOR: CHARCOAL VELVET, TRACELSS FINISH MOUNT ON 3/4" PLYWD. B-3 TILE BASE @ NON-TILED WALLS W/ PT-2 MFR: CAESAR CERAMICHE-VIRGINIA TILE STYLE: RELATE COLOR: MINE SIZE: 12"x24"x3/8" CUT - 4" FINISHED HEIGHT MORTAR: SCHLUTER ALL-SET, GRAY GROUT: TEC POWER GROUT - RAVEN TOP TRIM: SCHLUTER QUADEC 7/16", DARK ANTHRACITE TEXTURED B-4 BASE @ CARPET MFR: JOHNSONITE TRADITIONAL COLOR: CHARCOAL 4" W/ TOE ADHESIVE: PARABOND FUSION X	PT-2 WALL PAINT MFR: SHERWIN WILLIAMS - SUPER PAINT COLOR: IRON ORE SW 7069 FINISH: FLAT PT-3 WALL PAINT - ACCENT MFR: SHERWIN WILLIAMS - DURATION HOME COLOR: CUSTOM MATCH, SW 6868 REAL RED BASE FINISH: MATTE PT-4 WALL PAINT MFR: SHERWIN WILLIAMS - SUPER PAINT COLOR: EXTRA WHITE SW 7006 FINISH: SATIN PT-5 WALL PAINT MFR: SHERWIN WILLIAMS - SUPER PAINT COLOR: EVENING SHADOW 7662 FINISH: SATIN PT-6 CEILING PAINT MFR: SHERWIN WILLIAMS - SUPER PAINT COLOR: EXTRA WHITE SW 7006 FINISH: MATTE PT-7 CEILING PAINT MFR: SHERWIN WILLIAMS - SUPER PAINT COLOR: IRON ORE SW 7069 FINISH: MATTE
WALL TILE/PANELS	DOORS	CEILING
W-1 BACKSPASH TILE MFR: EQUIPE CERAMICAS/ M&S STYLE: COCO COLOR: AMBER GREY MATTE SIZE: 2' x 6' MORTAR: TEC DOUBLE DUTY GROUT: TEC POWER GROUT, SLATE GRAY PATTERN: VERTICAL 50% OFFSET W-2 UNDER BAR WALL TILE MFR: EQUIPE CERAMICAS/ M&S STYLE: COCO COLOR: BLACK HAT MATTE SIZE: 2' x 6" MORTAR: TEC DOUBLE DUTY GROUT: TEC POWER GROUT, RAVEN PATTERN: VERTICAL 50% OFFSET W-3 WALL TILE @ FIREPLACE LOUNGE MFR: CAESAR CERAMICHE - VIRGINIA TILE STYLE: RELATE COLOR: MINE SIZE: 12" X 24" X 3/8" MORTAR: TEC DOUBLE DUTY PLUS ADHESIVE GROUT: TEC POWER GROUT - RAVEN PATTERN: VERTICAL 33% OFFSET W-4 PERFORATED METAL PANELS MFR: MOZ MTRL: .063" PERFORATED ALUMINUM STYLE: 3/16" DIA. BY 5/16" STG. CTRS. COLOR: CLASSIC KHAKI FOG MATTE SIZE: VARIES W-5 FROSTED RESIN W/ PERFORATED METAL PANEL MFR: 3FORM WALL STYLE: FULLY FRAMED, TOP SUPPORT PARTITION JET BLACK MATTE STYLE: CUSTOM DIGITAL PRINT MATERIAL: VARIA 3/8" FINISH: SANDSTONE F01 FINISH W-6 PLYWOOD WALL PANEL MFR: STYLE: COLOR: SIZE: W-7 FRP WALL PANEL MFR: MARLITE STYLE: ARTIZAN CEMENT FINISH COLOR: 2410 - SKY NATURAL CONCRETE SIZE: 4'-0" x 10'-0"	DOOR AND FRAME ST-1 WOOD DOORS MFR: MINWAX COLOR: HABITAT MW 427 PT-2 HOLLOW METAL FRAMES MFR: SHERWIN WILLIAMS - SUPER PAINT COLOR: IRON ORE SW 7069 FINISH: FLAT	C-1 CEILING TILE CLOUD MFR: USG GRID: DONN BRAND IDENTITEE DXI FINELINE COLOR: WHITE PANEL: HALCYON - FL #98225 COLOR: WHITE SIZE: 24" x 24" x 1" C-2 CEILING TILE UPPER CEILING MFR: USG GRID: DONN BRAND IDENTITEE DXI FINELINE COLOR: FLAT BLACK PANEL: HALCYON - FL #98225 COLOR: FLAT BLACK SIZE: 24" x 24" x 1" C-3 CEILING TILE PERFORATED MFR: ARKTURA STYLE: VAPOR VERVE W/ FROSTED BACKER COLOR: T-GRID WHITE (MATTE) ALUMINUM POWDER COAT W/ FROSTED BACKER 2"x4"x1-1/2" C-4 GYP. BD. CLG. TO BE PAINTED. SEE PT-6 C-5 GYP. BD. CLG. TO BE PAINTED. SEE PT-7
COUNTERTOPS	CASEWORK	PULLS/ HANDLES
Q-1 QUARTZ @ COUNTERTOP MFR: MSI Q QUARTZ COLOR: MARBELLA WHITE	PL-1 CABINERY MFR: WILSONART TRACELSS COLOR: CHARCOAL VELVET 15504-31 PL-2 CABINERY MFR: WILSONART PRODUCT: SOLICOR HORIZONTAL GRADE LAMINATE .048" - 161 COLOR: CHARCOAL VELVET 15504-31 TRACELSS FINISH W/ EDGES	PU-1 CABINERY DOOR PULL MFR: HARDWARE RESOURCES ELEMENTS STYLE: KNOX, 128MM COLOR: MATTE BLACK 645-128MB PU-2 CABINERY DRAWER PULL MFR: HARDWARE RESOURCES ELEMENTS STYLE: KNOX, 224MM COLOR: MATTE BLACK 645-224MB

- NOTES TO FINISH:
- REF SHEET A121 CEILING PLAN FOR FINISH LOCATIONS.
 - ALL WALLS AT 9' A.F.F. ON UP, TO BE PAINTED PT-2.

- NOTES FOR TILE INSTALLATION
- FOLLOW PROPER TILE SETTING, GROUT APPLICATION AND DRYING PROCEDURES.
 - DO NOT WALK ON THE FLOOR FOR AT LEAST 72 HOURS. GROUT MUST HAVE THE PROPER CURING TIME.
 - FOLLOW INSTRUCTIONS FOR WEEKLY DEEP CLEAN CLEANING USING A HEAVY-DUTY STONE, TILE AND GROUT CLEANER* TO REMOVE GROUT HAZE FROM INITIAL INSTALLATION. MOST LIKELY, THERE WILL BE GROUT HAZE NOT VISIBLE TO THE NAKED EYE.
 - ALLOW FLOOR TO COMPLETELY DRY. FLOOR SHOULD THEN BE READY TO COVER.
 - ALL TILE SHOULD BE COVERED WITH RAM BOARD, PLYWOOD OR A SIMILAR MATERIAL AT ALL TIMES PRIOR TO OPENING.
 - NO CONSTRUCTION DUST, DIRT, OR GRIME SHOULD TOUCH THE PROPERLY CLEANED FLOOR. THIS IS DETRIMENTAL TO THE LONG-TERM CARE OF THE FLOOR.

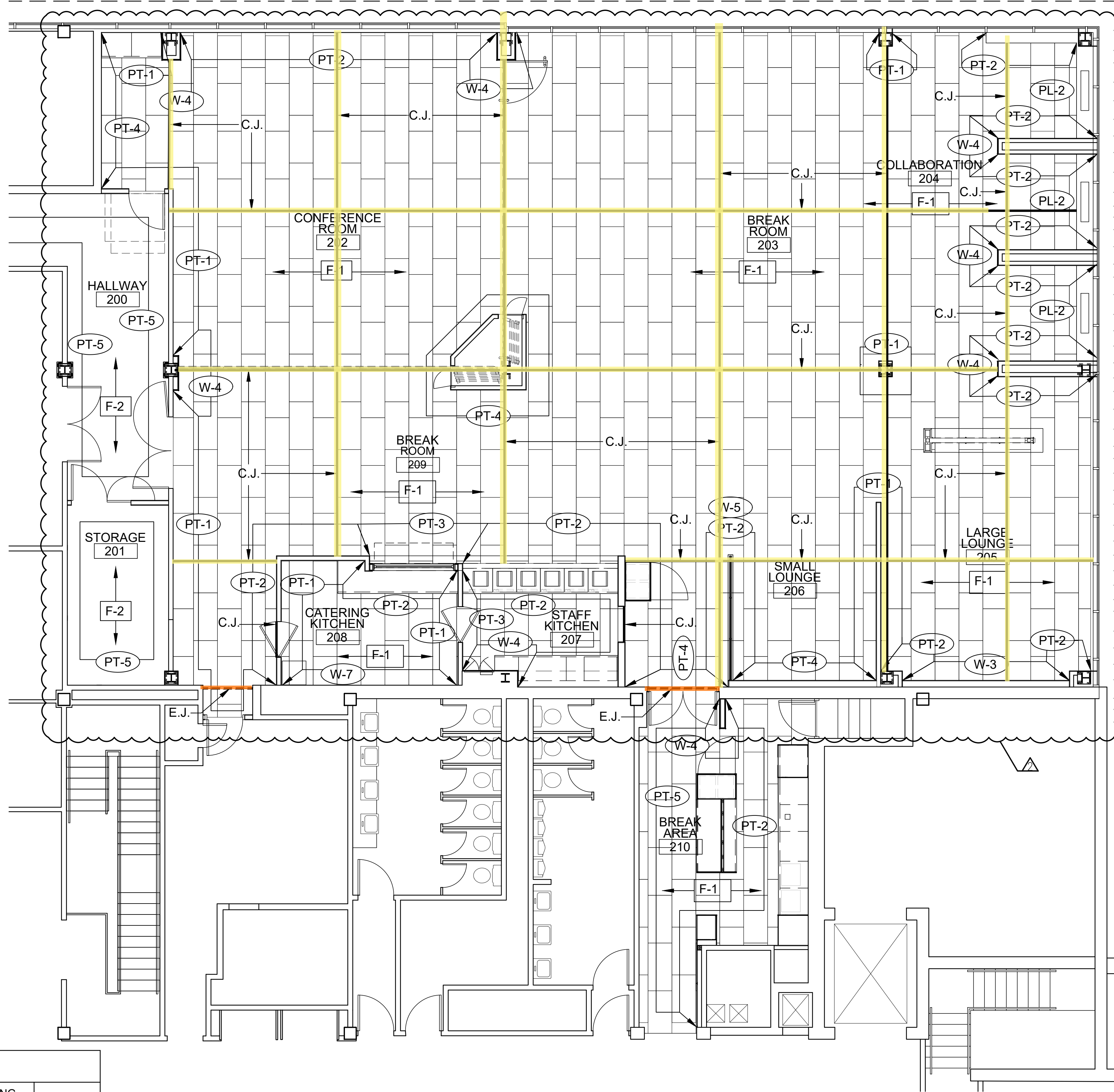
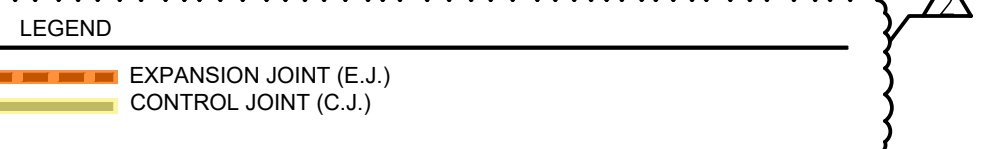

ROOM #	ROOM NAME	FLOOR FINISH	BASE FINISH	NORTH WALL	EAST WALL	SOUTH WALL	WEST WALL	CEILING FINISH	NOTES
200	HALLWAY	OWNER'S STOCK	EXISTING	PT-5	PT-5	PT-5	PT-5	EXISTING	-
201	STORAGE	OWNER'S STOCK	B-4	PT-5	PT-5	PT-5	PT-5	C-4	-
202	CONERENCE ROOM	F-1	B-1/B-2/B-3	PT-4/PT-1/W-4	PT-1/PT-2/W-4	PT-4/W-4	PT-4	C-1 / C-2 / C-4	-
203	BREAK ROOM	F-1	B-1	PT-4/PT-2/W-4	PT-1/W-4	PT-1	PT-4	C-1 / C-2 / C-4	-
204	COLLABORATION	F-1	B-3	PT-2/PT-1	PT-1	PL-2/W-4	PT-2	C-4 / C-1	-
205	LARGE LOUNGE	F-1	B-1/B-3	PT-2	PT-2/ PT-1	PT-2	PT-2/W-3	C-3 / C-4	-
206	SMALL LOUNGE	F-1	B-1	W-5/PT-2	-	PT-1	PT-4	C-4	△
207	STAFF KITCHEN	F-1	B-1/B-2	PT-3	PT-2	PT-2	PT-2/W-4/W-1	C-1	-
208	CATERING KITCHEN	F-1	B-1/B-2	PT-1	PT-2/PT-1	PT-1	W-7	C-1	-
209	BREAK ROOM	F-1	B-1/B-3	PT-1/W-4	PT-4	PT-2	PT-2/PT-3/PT-1/W-2	C-1 / C-2 / C-4	-
210	BREAK AREA	F-1	B-1/B-2	PT-5	PT-5/W-4/PT-2	PT-2/W-1/PT-5	PT-2/PT-5	C-1 / C-4	-

A4 FINISH FLOOR PLAN
 SCALE: 3/16" = 1'-0"
 0 2 4 8 FT

PLAN4ARCH
 ARCHITECTURE DESIGN www.plan4arch.com
 303 north main st., mcpherson kansas 67204-14353

Architect hereby expressly reserves its common law copyright and other property rights in these plans. These plans and drawings are not to be reproduced, changed, copied or assigned to any third party, in any form or manner whatsoever without first obtaining the express written permission of Plan 4 Architecture Design.

FINISH SCHEDULE

Farmers Alliance Mutual Insurance
 1122 North Main
 McPherson, Kansas 67460

Contract Date	
Rev No. 1 ADDM #1	04.08.2024
Rev No. 2 ADDM #2	04.18.2024
Rev No. 3	
Rev No. 4	
Rev No. 5	
Rev No. 6	
Project Number:	23.20
DWG File	A010.dwg
Designed By:	plan4
Drawn By:	GSC
Approved By:	plan4
Date:	03.25.24



SHEET NUMBER
A010

11 x 17 = 1/2 scale